

Referencia catastral: 616942471139561000120

DATOS DESCRIPTIVOS DEL INMUEBLE

Localización:
CL CANTO D'ALT Suelo
03792 ORBA [ALICANTE]

Clase: URBANO
Uso principal: Suelo sin edif.
Superficie construida:
Año construcción:

PARCELA

Superficie gráfica: 905 m2
Participación del inmueble: 99,999900 %
Tipo:

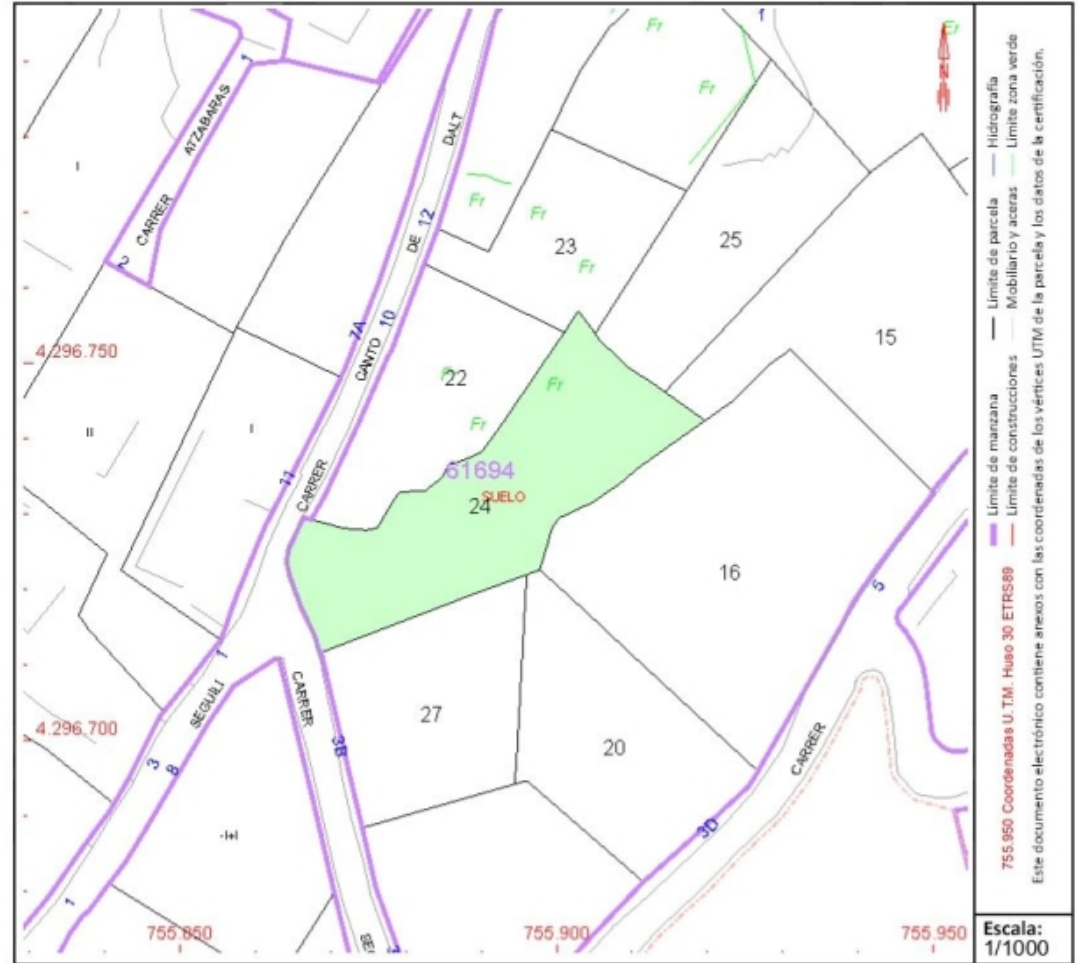

BOLIG ID: PEG-001512





Urbanización Orbeta

Grund til salg i Orba

€90,000

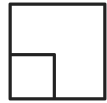
On this plot of 905 m2 you can build a house in two different heights. It is located in the Orbeta de Orba urbanization in the heart of the Costa Blanca. Beautiful views of the valley and the surrounding mountains. Very close to the town, which is about 10-15 minutes from the motorway that connects Alicante and Valencia. It is located near Dénia...

 0 m ²	 905
 0	 0



+34 609 97 72 62



www.bolig-udland.dk



info@bolig-udland.dk